

## **Brunswick Tel-E-Foul Lens Replacement 84-860770-000**

### **Packaging**

<b>Qty.</b>	<b>Part Number</b>	<b>Description</b>
1 ea.	84-200249-001	R.H. Return Tel-E-Foul Cover Lens
1 ea.	84-200249-002	L.H. Return Tel-E-Foul Cover Lens
2 ea.	11-006010-000	#4-40 x 1" Button Head Cap Screw
2 ea.	10-195001-000	#4 Washer
2 ea.	11-170000-001	#4-40 Self Locking Nut
1 ea.	84-900214-000	Instruction Sheet

### **Tools Needed**

- Power Drill
- Drill Bit Size: #29 or 9/64" (or 3.5 mm)
- 1/16" Allen Wrench (hex key)
- 1/4" Open Ended Wrench (spanner)

### **Instructions**

These instructions are designed for the replacement of the OEM Brunswick Tel-E-Foul Cover Lens (P/N 84-200249-000) with the new style lens (P/N 84-860770-000).

1. Start by removing the Tel-E-Foul cover from the approach surface and take it to a working surface.
2. Clean the opening for the Tel-E-Foul lens by removing any remaining adhesive from the previous lens.

3. Position the new lens into place. Using the hole in the new lens as a guide, drill a hole through the support post using a #29 drill bit. Refer to *Figure 1*.

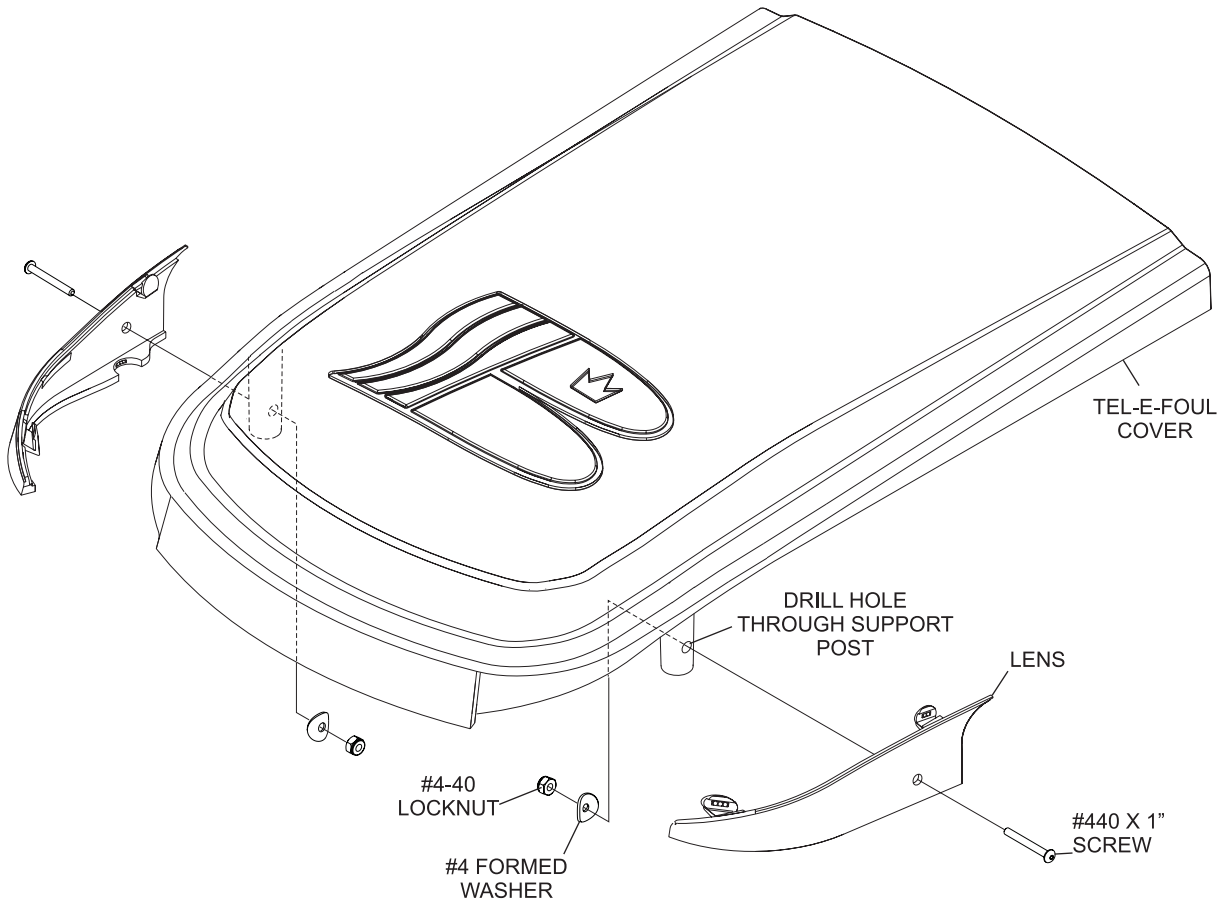

*Figure 1*

4. Secure the lens to the post with #4-40 x 1" screw, #4 formed washer and #4-40 locknut.



**CAUTION! Care should be taken not to over tighten the hardware. (Hand tighten to 5 in-lbs max.)**

5. Replace Tel-E-Foul cover over the foul unit and secure to the approach.